

Master Link Assemblies GT/S Grade 10

Product information

Designed for larger crane hooks and special hooks.

... [Read more](#)



Material: Alloy steel.

Finish: Violet powder coated.

Warning: Not to be heat-treated.

Safety factor: 4:1

Grade: 10

Master Link Assemblies GT/S Grade 10

Blueprint

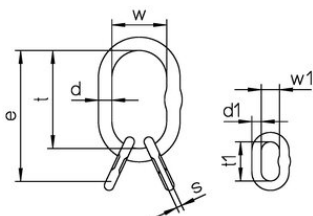

Technical data

Part code	Code	WLL ton	EWL	d mm	d1 mm	e mm	s mm	t mm	t1 mm	w mm	w1 mm	Weight kg
402100420260	GT/S-6-10	4.2	214	19	13	214	10	160	54	95	25	1.47
402100660260	GT/S-8-10	6.6	240	23	17	240	14	170	70	105	34	2.53
402101010260	GT/S-10-10	10.1	275	27	20	275	14	190	85	110	40	3.87
402101570260	GT/S-13-10	15.7	345	33	23	345	17	230	115	130	50	7.21
402102120260	GT/S-16-10	21.2	415	38	27	415	20	275	140	150	65	11.3