

Foundry Hook GHK/S Grade 10 - Clevis

Product information



Foundry Hooks are hooks with a bigger opening without safety latch often used in foundries.

... [Read more](#)

Material: Alloy steel.

Marking: According to standard, CE-marked

Temperature range: -40°C up to 380°C

Finish: Violet powder coated.

Standard: EN 818-4

Note: Always verify if hooks without safety latch are allowed for your application.

Warning: Not to be heat-treated.

Safety factor: 4:1

Grade: 10

Foundry Hook GHK/S Grade 10 - Clevis

Blueprint

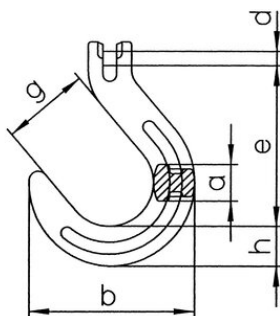

Technical data

Part code	Code	WLL ton	EWL mm	For chain Ø mm	a mm	b mm mm	d mm mm	e mm mm	g mm mm	h mm mm	Weight kg
402300250330	GHK/S-8-10	2.5	120	8	25	118	10	120	64	29	1.04
402300400330	GHK/S-10-10	4	140	10	32	143	12.5	140	76	35	1.74
402300670330	GHK/S-13-10	6.7	170	13	40	170	16	170	89	42	3.38