

Crosby Screw Clamp IPSC10 – Not for Lifting

Product information



The IPSC10 screw style clamp is suitable for use in positioning, pulling and turning steel plates and sections.

Features:

- Available in capacities of 1.5 and 3 metric tons.
- Jaw openings available: 0 to 60mm
- Suitable for steel with a surface hardness up to 300 HV10.
- Forged alloy steel body for strength and smaller size. Forged alloy components, where required.
- Individually Proof Tested to 2 times the Working Load Limit with certification.
- User manual with test certificate is included with each clamp.
- Maintenance and repair kits are available.

... [Read more](#)

Material: Alloy steel.

Marking: CE-marked, Logo, WLL, serial number, proofload test date and jaw opening.

Temperature range: -40°C up to +100°C

Warning: Not to be used as a lifting clamp.

Crosby Screw Clamp IPSC10 – Not for Lifting

Blueprint

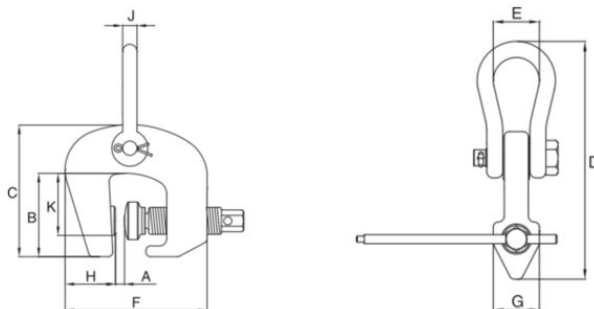

Technical data

Part code	WLL ton	Jaw width mm	Model	A mm	B mm	C mm	D, mm	E mm	F mm	G, mm	H, mm	J mm	K mm	Weight kg
502100150400270	1.5	0-40	1.5-IPSC	0-40	91	143	251	44	156	50	45	16	65	4.6
502100300600270	3	0-60	3-IPSC	0-60	109	175	310	51	200	62	55	19	83	8.4