

Quick Lift Double Swivel Ring SS QL DSR

Product information



The QLR is a double swivel ring that allows particularly fast anchoring. At the push of a button, it can be fixed in the threaded hole in a matter of seconds. Its double swivel ensures a perfect alignment with the sling.

The QL.DSR saves up to 80 % of time compared to screwing in a conventional lifting ring. The system works purely mechanically and thus requires no complex maintenance.

The swivel lifting ring QL.DSR is made of gradup steel, which stands for a better quality of the used raw materials. It has higher lifting capacities than fixed rings and has a safety factor of 5, which means that its breaking load is five times greater than the capacity indicated in the technical data sheet.

Compliant to directive machine 2006/42/CE

[... Read more](#)

Material: AISI 316L

Marking: According to standard, CE-marked, WLL , safety factor, individual traceability number (linked to Coditracer)

Temperature range: -20°C up to +200°C

Standard: EN 1677-1

except grade

Warning: WLL 3.5t (M30) SF 4:1

Safety factor: 5:1

Quick Lift Double Swivel Ring SS QL DSR

Blueprint

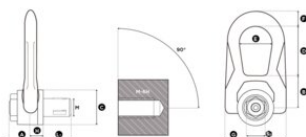

Technical data

Part code	WLL ton	Thread mm	Pitch mm	Torque Nm	A mm	B mm	C mm	D mm	E mm	F mm	G mm	H mm	L1 mm	S2 mm mm	M mm	Weight kg
4215SSQLDSRM8	0.25	M 8	1.25	20	31	30	30	38	27	14	53	9.5	17.5	18	M 8	0.3
4215SSQLDSRM10	0.4	M 10	1.5	30	31	30	30	38	27	14	53	9.5	19.5	18	M 10	0.3
4215SSQLDSRM12	0.65	M 12	1.75	60	40	40	45	53	38	17	76	13	23	27	M 12	0.9
4215SSQLDSRM14	0.7	M 14	2	80	40	40	45	53	38	17	76	13	23	27	M 14	0.9
4215SSQLDSRM16	1.05	M 16	2	100	40	40	45	53	38	17	76	13	27	27	M 16	0.9
4215SSQLDSRM20	1.7	M 20	2.5	160	55	55	60	83	55	25	115	19	30	40	M 20	2.6
4215SSQLDSRM24	2.5	M 24	3	180	55	55	60	83	55	25	115	19	36	40	M 24	2.6