

Dee Shackle Powertex PDSP

Product information



POWERTEX

The POWERTEX Dee Shackle PDSP is a high-strength lifting shackle designed for straight-line load applications where quick assembly is important. Supplied with an alloy steel screw pin, it allows fast and easy connection and disconnection in lifting setups that change frequently.

The dee shape is intended for in-line loading, making it suitable for direct attachment to lifting lugs, chains, and wire rope assemblies where controlled alignment is required. Manufactured from quenched and tempered alloy steel and hot dip galvanized, it is built for reliable use in construction, workshops, manufacturing, and general industrial lifting.

It complies with EN 13889, AS 2741 (generally), ASME B30.26, and meets the performance requirements of the US Fed. Spec. RR-C-271.

Choose the PDSP screw pin version when:

- The shackle is frequently assembled and removed
- Fast handling and efficiency are important
- The load is applied primarily in a straight line

Product benefits:

- **Screw pin for quick and easy opening**
Allows fast installation and removal, helping reduce downtime in lifting setups that change frequently.
- **Forged alloy steel, quenched and tempered, Grade 6**
Provides consistent strength and predictable performance in demanding lifting operations.
- **Safety factor 6:1**
Designed with a clear safety margin for overhead lifting applications.
- **Hot dip galvanized finish on body and screw pin** [... Read more](#)

Material: Forged alloy steel, supplied with screw pin.

Marking: According to standard, CE-marked, Powertex (PT or PTEX), WLL, size, grade and batch number.

Temperature range: -40°C up to +200°C

Finish: All parts hot dip galvanized. Screw pin additional powder painted.

Standard: EN 13889, AS 2741, ASME B30.26

Safety factor: 6:1

Grade: 6

Dee Shackle Powertex PDSP

Blueprint

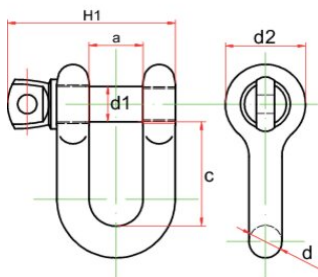

Technical data

Part code	WLL ton	Size inch	a* mm	c* mm	d mm	d1 mm	d2 mm	H1 mm	Weight kg
420100050820	0.5	1/4	13	22	6.5	8	17.5	38	0.042
420100080820	0.75	5/16	13.5	25.5	8	9.5	21	42.5	0.068
420100100820	1	3/8	17	30.9	10	11.2	25	51.5	0.13
420100150820	1.5	7/16	18.5	36.4	11	12.7	27	58	0.185
420100200820	2	1/2	20.6	41.4	12.7	15.8	30.5	67	0.29
420100330820	3.25	5/8	27	51	16	19	40	85	0.58
420100480820	4.75	3/4	32	63	19	22	48	98.5	0.93
420100650820	6.5	7/8	37	72	22	25	54	114	1.45
420100850820	8.5	1	43.5	81.75	26.5	28	60	129.5	2.06
420100950820	9.5	1-1/8	48	94	29	32	68	144	2.91
420101200820	12	1-1/4	53	102	32	35	76	157	4.15
420101350820	13.5	1-3/8	59	113.5	35	38	84	171	5.5
420101700820	17	1-1/2	62	123	38	42	92	186	6.97
420102500820	25	1-3/4	75	148	45	50	106	227	11.22