

## Female Double Swivel Ring Codipro SS FE DSR

---

### Product information



SS FE DSR M Stainless steel female double swivel ring.

The stainless steel version of the double swivel ring, FE.DSR, can be used in humid, corrosive, chemical, maritime environment. Its double articulation allows it to line up perfectly with the sling.

#### Features:

- Rotatable under load.

... [Read more](#)

---

**Material:** AISI 316 L

**Marking:** According to standard, CE-marked

**Temperature range:** -20°C up to + 200°C

**Standard:** EN 1677-1

*except grade/WLL*

**Safety factor:** 5:1

## Female Double Swivel Ring Codipro SS FE DSR

### Blueprint

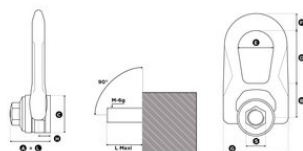

### Technical data

Part code	WLL ton	Thread	Torque Nm	A mm	B mm	C mm	D, mm	E mm	F mm	G, mm	H, mm	L max. mm mm	S mm	Weight kg
4215SSFEDSRM8	0.3	M 8 (x1,25)	6	43	40	45	53	38	17	76	13	43	20	0.9
4215SSFEDSRM10	0.5	M 10 (x1,50)	10	43	40	45	53	38	17	76	13	43	20	0.9
4215SSFEDSRM12	0.8	M 12 (x1,75)	15	43	40	45	53	38	17	76	13	43	20	0.9
4215SSFEDSRM14	1	M 14 (x2)	30	43	40	45	53	38	17	76	13	43	20	0.9
4215SSFEDSRM16	1.4	M 16 (x2)	50	43	40	45	53	38	17	76	13	43	20	0.9
4215SSFEDSRM18	1.4	M 18 (x2,5)	70	62	55	58	83	56	25	115	19	62	24	2.6
4215SSFEDSRM20	1.4	M 20 (x2,5)	100	62	55	58	83	56	25	115	19	62	24	2.6
4215SSFEDSRM22	2.2	M 22 (x2,5)	120	62	55	58	83	56	25	115	19	62	24	2.6