

Snatch Block McKissick 421 with Shackle - Champion

Product information



The McKissick snatch block 421 Champion from Crosby is a snatch block fitted with a shackle. Can be delivered with bronze bushing (BB) and with roller bearing (RB).

Features:

- Bolt for opening feature is retained, to ensure no lost bolts.
- Opening feature permits easy insertion of rope without reeving, or while the block is suspended.
- Center pin equipped with pressure lube fitting.
- All sizes feature sheave grooves suited for a range of wire line diameters.
- Meets or exceeds all requirements of ASME B30.26 including identification ductility, design factor, proof load and temperature requirements.
- Meet other critical performance requirements including fatigue life and material traceability, not addressed by ASME B30.26.

... [Read more](#)

Material: Forged steel.

Marking: CE-marked

Snatch Block McKissick 421 with Shackle - Champion

Blueprint

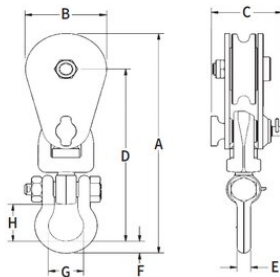

Technical data

Part code	Rope Ø range mm	WLL ton	Sheave dia mm	Bearing	A mm	B mm	C mm	D mm	E mm	F mm	G, mm	H, mm	Weight
424101500140	19-22	15	203	BB	584	206	129	437	38	44	79	79	26.8
424101500145	19-22	15	203	RB	584	206	129	437	38	44	79	79	26.8
424101500146	19-22	15	254	BB	629	257	129	456	38	44	79	79	30.8
424101500147	19-22	15	254	RB	629	257	129	456	38	44	79	79	30.8