

Beam Clamp - IPTK

Product information



This IPTK series beam clamp is suitable for use as a temporary tackle eye for horizontal lifting and transportation of steel (H) beams, profiles and structures. Can also be used as upside down attached (temporary) lifting point.

Features:

- Available in capacities of 2 through 25 metric tons.
- Wide variety of jaw openings available: 75 to 1020 mm.
- Welded alloy steel body for strength and smaller size. Forged alloy components, where required.
- Individually Proof Tested to 2 times the Working Load Limit with certification.
- User manual with test certificate is included with each clamp.
- Maintenance and repair kits are available.
- All sizes are RFID EQUIPPED.

... [Read more](#)

Material: Steel

Marking: According to standard, CE-marked, WLL, Logo, Jaw opening, Serial number

Temperature range: -40°C up to +100°C

Standard: EN 13155

Beam Clamp - IPTK

Blueprint

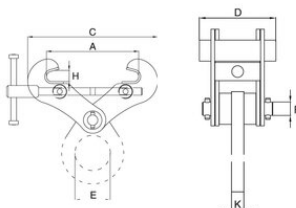

Technical data

Part code	WLL ton	Jaw width mm	Model	A mm	C mm	D mm	E mm	H mm	K mm	Weight kg
502100201900230	2	75-190	2-IPTK	75-190	A+80	125	75	25	20	6
502100301900230	3	75-190	3-IPTK	75-190	A+80	125	75	25	20	6.5
502100402800230	4	150-280	4-IPTK	150-280	A+100	125	75	35	20	8.5
502100503500230	5	120-350	5-IPTK	120-350	A+195	125	75	40	20	11
502102501020230	25	450-1,020	25-IPTK	450-1020	A+220	500	125	76	45	225