

Superclamp serial AC

Product information



Adjustable beam clamps for establishing a semi-permanent suspension point for steel profiles.

Properties

- Easy and quick mounting.
- Suitable for various steel profiles.

... [Read more](#)

Marking: According to standard, CE-marked

Standard: EN 12100, EN 13157

Superclamp serial AC

Blueprint

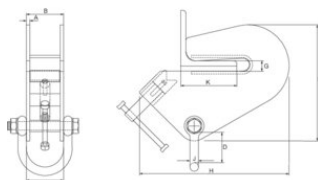

Technical data

Part code	Code	WLL ton	Beam width mm	Model	A mm	B mm	C mm	D mm	E mm	G mm	H mm	J mm	K mm	Weight kg
502300051500300	8717365017001	0.5	15	AC1	4	65	70	102	206	15	258	16	38-101	4.5
502300101500300	8717365017018	1	15	AC2	6	69	70	96	206	15	258	16	38-101	5.5
502300151500300	8717365017025	1.5	15	AC3	8	86	90	73	270	15	346	20	50 - 152	11
502300302540300	8717365017032	3	25.4	AC4	10	90	102	101	343	25.4	490	20	101-203	21.5