

CPH pipe lifting hooks

Product information



Properties

- Jaw is covered with a special high quality pressure resistant plastic.
- These hooks must always be used in pairs.

Application

- For horizontal lifting and transporting of steel and concrete pipes without damaging the product.

... [Read more](#)



Features: WLL = per pair

Marking: According to standard, CE-marked

Standard: EN 13155, EN 12100

Note: Exclusive fasteners.

CPH pipe lifting hooks

Blueprint

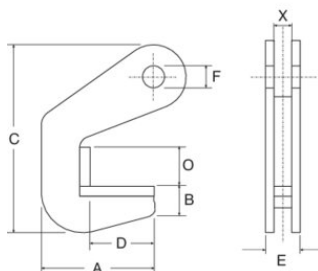

Technical data

| Part code | GTIN No. | WLL ton | Jaw width mm | Model | A mm | B mm | C mm | D mm | E mm | F mm | O mm | X mm | Weight kg/pair |
|-------------|---------------|---------|--------------|----------|------|------|------|------|------|------|------|------|----------------|
| 50213313025 | 8717365015304 | 1.5 | 40 | CPH-1.5 | 120 | 32 | 185 | 70 | 41 | 16 | 40 | 23 | 3.2 |
| 50213313027 | 8717365015311 | 3 | 40 | CPH-3.0 | 120 | 32 | 185 | 70 | 41 | 16 | 40 | 23 | 3.2 |
| 50213313029 | 8717365015328 | 4 | 50 | CPH-4.0 | 140 | 58 | 180 | 70 | 41 | 26 | 50 | 23 | 6 |
| 50213313031 | 8717365015335 | 6 | 50 | CPH-6.0 | 140 | 58 | 180 | 70 | 41 | 26 | 50 | 23 | 6 |
| 50213313033 | 8717365015342 | 8 | 70 | CPH-8.0 | 140 | 58 | 200 | 70 | 45 | 26 | 70 | 25 | 7.2 |
| 50213313034 | 8717365023590 | 10 | 70 | CPH-10.0 | 140 | 58 | 200 | 70 | 86 | 26 | 70 | 44 | 10 |
| 50213313035 | 8717365258725 | 12 | 70 | CPH-12.0 | 140 | 58 | 200 | 70 | 86 | 26 | 70 | 44 | 12 |
| 50213313037 | 8717365258732 | 15 | 70 | CPH-15.0 | 155 | 75 | 250 | 70 | 100 | 26 | 70 | 59 | 18 |
| 50213313039 | 8717365258749 | 20 | 70 | CPH-20.0 | 155 | 75 | 250 | 70 | 100 | 26 | 70 | 59 | 20 |