

CHV horizontal adjustable lifting clamps

Product information



REMA[®]

Adjustable lifting clamp for safe lifting and moving of packages and single plates in horizontal position. Always use these clamps per pair.

... [Read more](#)

Marking: According to standard, CE-marked

Standard: EN 13155, EN 12100

Safety factor: 5

CHV horizontal adjustable lifting clamps

Blueprint

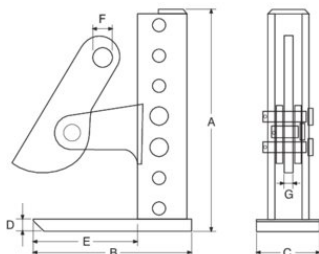

Technical data

Part code	GTIN No.	WLL ton	Jaw width mm	Model	A mm	B mm	C mm	D mm	E mm	F mm	G mm
R3315011	8717365015441	1.5	3-180	CHV-1.5	290	200	90	15	135	30	20
R3315013	8717365015458	1.5	3-300	CHV-1.5X	410	200	90	15	135	30	20
R3315015	8717365015465	3	3-180	CHV-3.0	300	235	105	20	165	30	20
R3315017	8717365015472	3	3-300	CHV-3.0X	410	235	105	20	165	30	20
R3315019	8717365015489	4.5	3-180	CHV-4.5	300	235	105	20	165	30	20
R3315021	8717365015496	4.5	3-420	CHV-4.5X	535	235	105	20	170	30	20
R3315023	8717365015502	6	3-180	CHV-6.0	305	250	120	25	160	30	20
R3315025	8717365015519	6	3-420	CHV-6.0X	540	250	120	25	165	30	20
R3315027	8717365015526	9	3-180	CHV-9.0	305	250	120	25	160	30	20
R3315029	8717365015533	9	3-420	CHV-9.0X	540	250	120	25	165	30	20