

## RSH D-shackle AISI 316 (G6) AISI (Grade 6)

### Product information



## CARTEC

Grade 6 Stainless Steel Chain Slings and components are meticulously crafted using top-tier stainless steel (AISI 316), our slings are not just durable but also versatile. With the availability of individual components, we ensure a sustainable and customizable solution tailored to your specific lifting requirements. Our stainless steel assemblies are trusted across a myriad of industries such as construction, food & beverage, healthcare, aerospace, marine, and beyond.

### Utilization Features:

1. **Durability:** Made with premium AISI 316 stainless steel, ensuring longevity and resistance to corrosion.
2. **Versatility:** Suitable for a range of lifting operations with various assembly options.
3. **Safety:** Comes with a CE-mark and a safety factor of 4, ensuring utmost safety during operations.
4. **Adaptability:** Individual component availability for a tailored lifting solution.

### Markets/Applications:

- **Construction:** Ideal for heavy-duty lifting and construction site operations.
- **Food & Beverage:** Stainless steel ensures hygiene and cleanliness, making it perfect for food-related lifting tasks.
- **Medical:** Suitable for lifting medical equipment and supplies.
- **Aerospace:** Can be used for lifting aerospace components.
- **Marine:** Resistant to corrosion, making it perfect for marine applications. [... Read more](#)

**Material:** AISI 316

**Marking:** According to standard, CE-marked

**Standard:** EN 818-4

**Safety factor:** 4

**Grade:** 6

## RSH D-shackle AISI 316 (G6) AISI (Grade 6)

### Blueprint

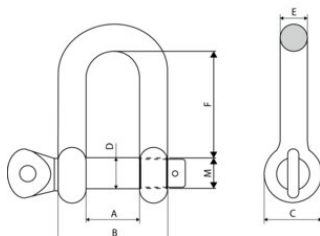

### Technical data

Part code	WLL ton	Size	Model	A mm	B mm	C mm	D mm	E mm	F mm	Mmm mm	Weight kg
420100050930	0.5	M10	RSH005 500 KG	18	34	18	9	8	33	M10	0.1
420100130930	1.25	M14	RSH012 1250 KG	25	49	25	13	12	40	M14	0.22
420100200930	2	M18	RSH020 2000 KG	32	64	32	17	16	60	M18	0.52
420100320930	3.2	M22	RSH032 3200 KG	41	79	47	21	19	78	M22	0.8
420100500930	5	M30	RSH050 5000 KG	56	106	60	29	25	109	M30	2.2