

RCMC masterlink 3-4 leg AISI 316 (Grade 6)

Product information

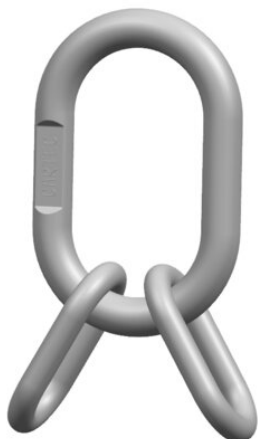

CARTEC

Grade 6 Stainless Steel Chain Slings and components are meticulously crafted using top-tier stainless steel (AISI 316), our slings are not just durable but also versatile. With the availability of individual components, we ensure a sustainable and customizable solution tailored to your specific lifting requirements. Our stainless steel assemblies are trusted across a myriad of industries such as construction, food & beverage, healthcare, aerospace, marine, and beyond.

Utilization Features:

1. **Durability:** Made with premium AISI 316 stainless steel, ensuring longevity and resistance to corrosion.
2. **Versatility:** Suitable for a range of lifting operations with various assembly options.
3. **Safety:** Comes with a CE-mark and a safety factor of 4, ensuring utmost safety during operations.
4. **Adaptability:** Individual component availability for a tailored lifting solution.

Markets/Applications:

- **Construction:** Ideal for heavy-duty lifting and construction site operations.
- **Food & Beverage:** Stainless steel ensures hygiene and cleanliness, making it perfect for food-related lifting tasks.
- **Medical:** Suitable for lifting medical equipment and supplies.
- **Aerospace:** Can be used for lifting aerospace components.
- **Marine:** Resistant to corrosion, making it perfect for marine applications. [... Read more](#)

Material: AISI 316

Marking: According to standard, CE-marked

Standard: EN 818-4

Safety factor: 4

Grade: 6

RCMC masterlink 3-4 leg AISI 316 (Grade 6)

Blueprint

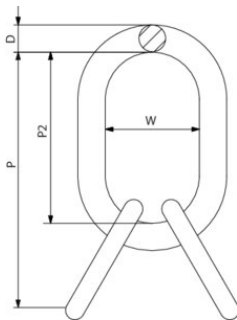

Technical data

Part code	Code	WLL ton	Size	Model	For chain, 3-4-leg mm	Pmm mm	D, mm	P2 mm mm	Wmm mm
400100170100	8717365176722	1.7	6	RCMC06-6MM 3+4 SPR.	6	154	13	110	60
400100260100	8717365176739	2.6	7	RCMC07-7MM 3+4 SPR.	7	164	16	110	60
400100340100	8717365176746	3.35	8	RCMC08-8MM 3+4 SPR.	8	205	18	135	75
400100530100	8717365176753	5.25	10	RCMC10-10MM 3+4 SPR.	10	245	22	160	90
400100890100	8717365176760	8.9	13	RCMC13-13MM 3+4 SPR.	13	295	26	180	100