

Dynamometer 05T with remote control

Product information

**REMA[®]**

Mechanical properties

- Aluminum housing.
- Alloy steel pulling unit.
- Test load 2 x WLL (without losing accuracy).
- Safety factor 5 x WLL.
- International Protection Rating / Ingress Protection: IP65 (EN60529).

Electrical specifications

- Alkaline battery (3 x AA type).
- Battery operating time about 180 hours.

Electronic specifications

- Operating temperature range between -5 ° C to + 55 ° C.
- Accuracy up to approx. 0.1% of the reading value.
- Battery indicator.

Standard delivery

- Bow shackles (3,2T and 6,3T).
- Remote control to tare.

Option

- Bow shackle from 10T.

... [Read more](#)

Marking: According to standard, CE-marked

Standard: EN 12100, EN 13155, EN 13889

Note: Includes plastic case, manual and calibration report.

Safety factor: 5

Dynamometer 05T with remote control

Blueprint

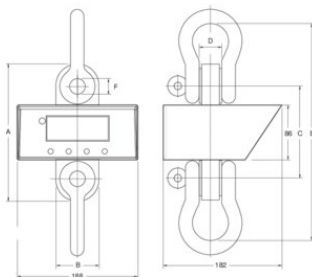

Technical data

Part code	GTIN No.	WLL ton	Model	Shackle	Resolution kg	A mm	B mm	C mm	D mm	E mm	F mm	Weight kg
60971514005	8717365110986	3.2	DSD05T-3.2T	3,25t in.	1	199	69	130	25	269	20	4.7
60971514007	8717365110993	6.3	DSD05T-6.3T	6,5t in.	2	213	69	144	35	348	26	7
60971514009	8717365112003	10	DSD05T-10.0T	12t ex.	5	265	100	181	50	455	36	9.6