

REMA 211/211BF push trolley

Product information



Suitable for various profiles, with both a straight and an inclined flange.

Properties

- Suitable for flat or bevel flange
- Adjustable flange width by adding or removing rings.
- Solid steel wheels, bearing of maintenance-free ball bearings.
- Short construction height in combination with REMA Select 200 OD hoist 0.5 / 1.0 / 2.0T, by link that replaces the upper hook.
- Wheel rupture supports and anti-surge protection ensure optimum safety.
- **211** type, standard version.
- **211BF** type, wide flange version.

... [Read more](#)

Marking: According to standard, CE-marked

Standard: EN 12100, EN 13157

REMA 211/211BF push trolley

Blueprint

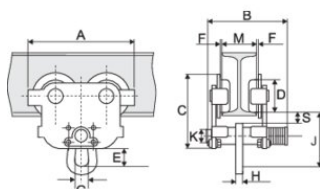

Technical data

Part code	GTIN No.	WLL kg	Beam width	Model	Minimum radius mm	A mm	B mm	C mm	D mm	E mm	F mm	G mm	H mm	J mm	K mm	S mm	Weight kg
50250924000	8717365260261	250	50-152	211-0.25-50/152	800	188	208	137	50	29	1,5~3	28	6	104	20	27	4.6
50250924001	8717365260278	500	50-135	211-0.5-50/135	800	205	198	150	55	30	1,5~3	28	8	111	28	27	6.8
50250924101	8717365261947	500	130-215	211BF-0.5-130/215	800	205	278	150	55	30	1,5~3	28	8	111	28	27	6.8
50250924102	8717365261954	500	215-300	211BF-0.5-215/300	800	205	363	150	55	30	1,5~3	28	8	111	28	27	6.8
50250924003	8717365260285	1,000	55-140	211-1.0-55/140	1,000	242	211	174	68	30	1,5~3	32	10	118	32	28	11.2
50250924201	8717365261961	1,000	140-215	211BF-1.0-140/215	1,000	242	286	174	68	30	1,5~3	32	10	118	32	28	11.2
50250924202	8717365261978	1,000	215-300	211BF-1.0-215/300	1,000	242	371	174	68	30	1,5~3	32	10	118	32	28	11.2
50250924005	8717365260292	2,000	65-155	211-2.0-65/155	1,100	270	238	194	80	49	1,5~3	40	12	147	36	27	16.9
50250924301	8717365261985	2,000	150-300	211BF-2.0-150/230	1,100	270	313	194	80	49	1,5~3	40	12	147	36	27	16.9
50250924302	8717365261992	2,000	230-300	211BF-2.0-230/300	1,100	270	383	194	80	49	1,5~3	40	12	147	36	27	16.9
50250924007	8717365260308	3,000	90-180	211-3.0-90/180	1,300	325	246	234	100	60	1,5~3	49	14	177	44	29	28.6
50250924401	8717365262005	3,000	160-230	211BF-3.0-160/230	1,300	325	316	234	100	60	1,5~3	49	14	177	44	29	28.6
50250924402	8717365262012	3,000	230-300	211BF-3.0-230/300	1,300	325	386	234	100	60	1,5~3	49	14	177	44	29	28.6
50250924009	8717365260315	5,000	90-180	211-5.0-90/180	1,500	370	280	267	110	79	1,5~3	59	16	219	55	29	44.8
50250924501	8717365262029	5,000	180-230	211BF-5.0-180/230	1,500	370	330	267	110	79	1,5~3	59	16	219	55	29	44.8
50250924502	8717365262036	5,000	230-300	211BF-5.0-230/300	1,500	370	330	267	110	79	1,5~3	59	16	219	55	29	44.8