

REMA 116 push trolley

Product information



REMA[®]

Properties

- Adjustable flange by adding or removing rings.
- Suitable for various profiles, with flat or bevel flange.
- Equipped with solid steel machined wheels.
- Bearing by maintenance-free ball bearings.
- Wheel rupture supports and tilt protection provide extra safety.

... [Read more](#)

Marking: According to standard, CE-marked

Standard: EN 12100, EN 13157

REMA 116 push trolley

Blueprint

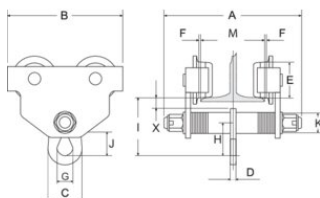

Technical data

Part code	GTIN No.	WLL kg	Beam width mm	Model	Minimum radius mm	A mm	B mm	C mm	D mm	E mm	F mm	G mm	H mm	I mm	J mm	X mm	K mm	Weight kg
50250921001	8717365003066	500	50-152	116-0.5	800	245	199	51	6	55	1.5~3	24	37	105	25	25	24	6.5
50250921003	8717365003073	1,000	64-203	116-1.0	1,000	311	246	62.5	8	68	1.5~3	30	46	125	31	31	30	10.5
50250921005	8717365003080	2,000	88-203	116-2.0	1,100	327	276	76	12	80	1.5~3	36	58	150	40	40	36	17.5
50250921007	8717365003097	3,000	100-203	116-3.0	1,300	343	332	86	13.6	100	1.5~3	42	90	171	69	69	42	27
50250921009	8717365003103	5,000	114-203	116-5.0	1,400	355	377	109	16.4	110	1.5~3	48	110	196	86	86	48	41